



An ISO 9001
Certified company

OD Series

OD-50DXC



Why Choose OD the Series?

The OD series of enclosures are the ultimate choice for your outdoor racking requirements. Being made of our own rugged Alumiflex®, you'll find it noticeably lighter than steel, yet strong enough to rack even the heaviest equipment. When choosing the OD series, you have handpicked the highest value in American construction. The OD-50DXC includes the standard features you have come to expect with DDB, incorporating the versatile strut system for adjustable racking, the security of a 3-point locking system and our patented Alumishield® solar cap to manage heat loads. For those who need more than just our standard enclosure, DDB can also make a truly customized solution with our many available options including HVAC, providing a climate-controlled environment for any electronic equipment, electrical load panels and cable entry solutions to name a few. All of this comes together to create an enclosure able to meet all of the unique needs your customers have been seeking. DDB offers a state-of-the-art design, a competitive price, benchmark lead times and a guaranteed delivery, all backed up with an industry leading 15-year warranty on every enclosure. Put DDB's substantial stock to work for you today. Contact our professional staff to assist you with your made-to-order solution.



Features

- 0.125" Aluminum Construction
- Stainless Steel External Hardware/Hinge
- 3 Point Lock System
- Heavy Duty Out-Door Construction
- Front and Rear Access
- Custom Colors Available
- Cream and Red Powder-Coat in Stock
- Flexible and Scalable
- 15 Year Warranty
- Quick Shipping

Application Types

- Telecommunications
- Wireless/Broadband
- Fiber Optics
- Back Haul
- Small Cell/DAS
- Public Safety
- Utility
- Base Station
- Military
- Trailer-Based Communications
- Wi-Fi
- LTEE/4G/5G



Industry Standards:

- NEMA 3R as shown
- NEMA 4 and 4X configurable (unlisted to environmental rating)
- OD Series Listed to UL 50/50E Type 4 Available**
- ETL listed to UL Standard 60950-1/CSA 22.2C

2301 S. HWY 77 Pauls Valley, OK 73075

T: (800) 753-8459 – F: (877) 220-7236

sales@ddbunlimited.com www.ddbunlimited.com

Weight and Dimensions

Approximate Exterior Enclosure Dimensions:

51"H x 28"W x 30"D

Shipping Dimensions:

32"W x 42"L - Palletized

Approximate Shipping Weight:

160lbs.

OD Series

OD-50DXC



Features

1. Solar Shield (Alumishield)
2. 19" Adjustable Racking Rails
3. Rear Access Door
4. Stainless Steel Door Hinge
5. 3 Point Locking System
6. Powder-Coat Cream
7. Reusable Vent Filters

2301 S. HWY 77 Pauls Valley, OK 73075

T: (800) 753-8459 – F: (877) 220-7236

sales@ddbunlimited.com www.ddbunlimited.com

WEB DRAWING (NOT FOR FABRICATION)

REVISIONS		
REV.	DESCRIPTION	DATE
A	Web Drawing per DR-00425	11/15/2011
B	Add new components and DWG template to WEB DWG per DR-00920	5/12/2014
C	UPDATED WITH 2019 FORMAT	2/25/2019

STANDOFFS STANDARD FOR OPTIONAL LIGHTING OVER EACH DOOR FRONT AND REAR

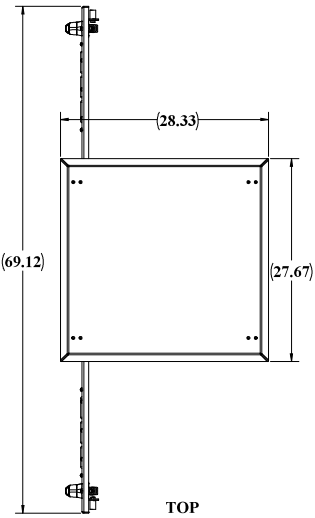
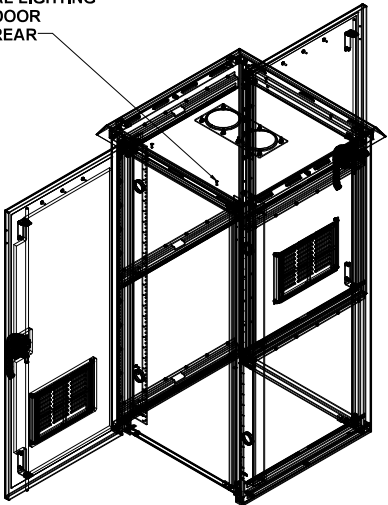

TOP

CEILING LOUVERS

FRONT RAILS STANDARD

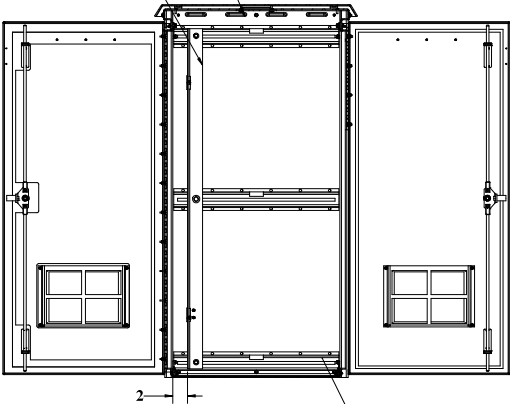

SECTION A-A
SCALE 1 : 8

3 R-STRUTS FOR RAIL ADJUSTMENT

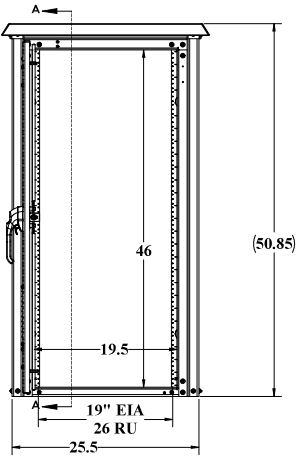

FRONT

3 POINT LOCKING

FILTERED VENTS

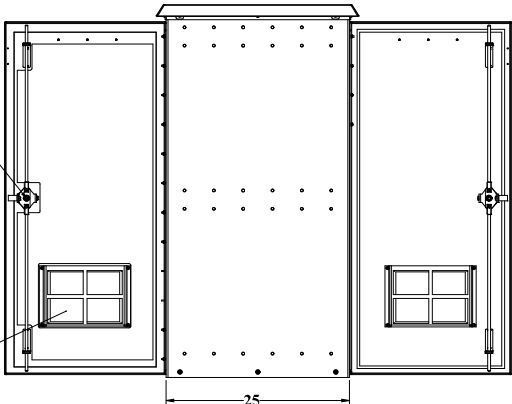

RIGHT SIDE

WEB DRAWING (NOT FOR FABRICATION)

UNLESS OTHERWISE SPECIFIED:		NAME	DATE	DDB Unlimited Inc.		
DIMENSIONS ARE IN INCHES		Model by:	0208	OD Family Enclosures		
APPROVAL		Drawn by:	Marcelo	Enclosure, OD, 96, DX		
DESIGNED AND CHECKED		Sales Rep:	Boysen C	SITE		
FOR FABRICATION		Q.A. Appr:	alchm	Cage Code:		
FOR ASSEMBLY		Prod.Mgr.:	Chad	DWG. NO.:		
FOR SHIPMENT				D		
MATERIAL: 90% POLYESTER 10% ALUMINUM				38515		
PAINT: POWDER COAT, WHITE				SCALE: 1:32		
DO NOT SCALE DRAWING				WEIGHT: 133 lbs		
				SHEET 1 OF 3		

WEB DRAWING (NOT FOR FABRICATION)

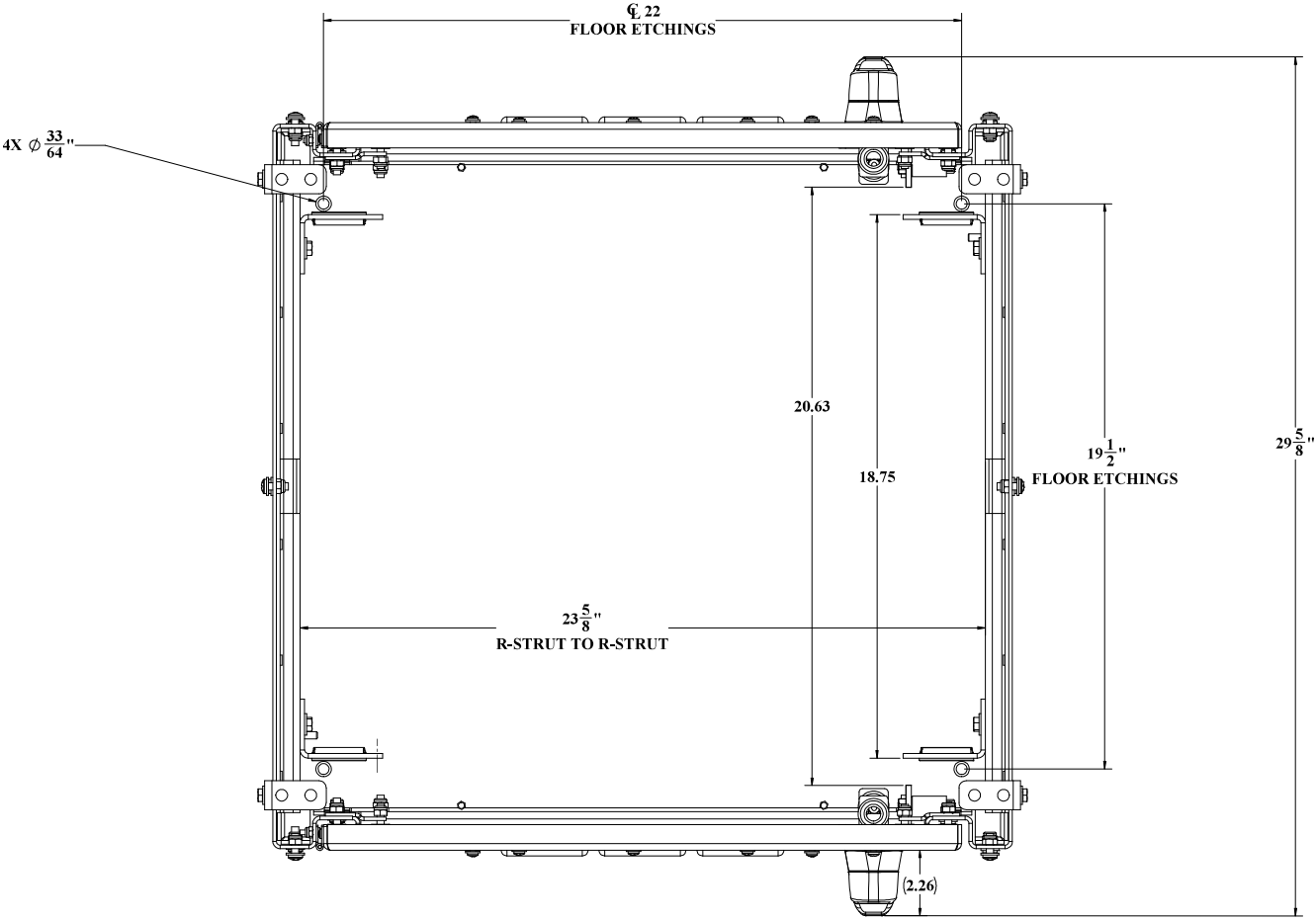

TOP VIEW (NO CEILING OR ALUMASHIELD SHOWN)

WEB DRAWING (NOT FOR FABRICATION)

UNLESS OTHERWISE SPECIFIED:		NAME	DATE	DDB Unlimited Inc.			
DIMENSIONS ARE IN INCHES		Model by:	6/08	OD Family Enclosures			
PARTS LIST		Drawn by:	Marcel	OD Family Enclosures, DX, Closed			
ALL DIMENSIONS ARE IN INCHES		Sales Rep:	Boys C				
ALL DIMENSIONS ARE IN INCHES		Q.A. Appr:	alchm				
ALL DIMENSIONS ARE IN INCHES		Prod. Mgr:	Chad				
MATERIAL: 6061-T6 ALUMINUM		Sheet Number:		SHEET	Cage Code:	DWG. NO.:	REV
PAINT: ANODIZED ALUMINUM				D	38515	00426	C
DO NOT SCALE DRAWING				SCALE: 1:32 WEIGHT: 93 lbs. SHEET 2 OF 3			

WEB DRAWING (NOT FOR FABRICATION)

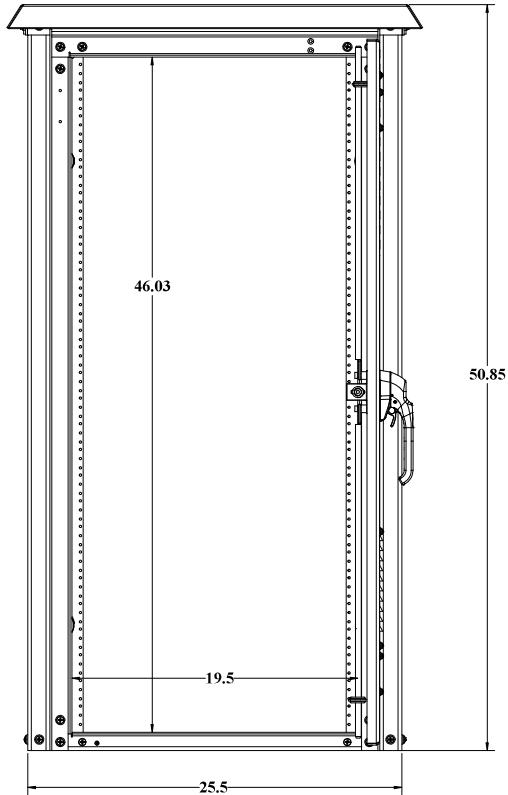

BACK VIEW GASKET NOW SHOWN

WEB DRAWING (NOT FOR FABRICATION)

UNLESS OTHERWISE SPECIFIED:				NAME		DATE		DDB Unlimited Inc.			
DIMENSIONS ARE IN INCHES				Model by:	DOB	11/15/2011		OD Family Enclosures			
APPROVAL				Drawn by:	Marcel	05/08/19		Endnote: OD, 90, DX			
FOR PLACING AND INSTALLATION				Sales Rep:	Boyle C	11/16/11		SIZE	Cage Code:	DWG. NO.:	REV
FOR PLACING AND INSTALLATION				Q.A. Appr:	John	04/15/19		D	38515	00426	C
FOR PLACING AND INSTALLATION				Prod.Mgr.:	Chris	04/15/19		SCALE: 1:32 WEIGHT: 133 lbs.			
FOR PLACING AND INSTALLATION				Checked:	Thomas			SHEET 3 OF 3			
FOR PLACING AND INSTALLATION				DO NOT SCALE DRAWING							