



An ISO 9001  
Certified company

# OD Series

## OD-30DXC



### Why Choose the OD Series?

The OD series of enclosures are the ultimate choice for your outdoor racking requirements. Being made of our own rugged Alumiflex®, you'll find it noticeably lighter than steel, yet strong enough to rack even the heaviest equipment. When choosing the OD series, you have handpicked the highest value in American construction. The OD-30DXC includes the standard features you have come to expect with DDB, incorporating the versatile strut system for adjustable racking, the security of a 3-point locking system and our patented Alumishield® solar cap to manage heat loads. For those who need more than just our standard enclosure, DDB can also make a truly customized solution with our many available options including HVAC, providing a climate-controlled environment for any electronic equipment, electrical load panels and cable entry solutions to name a few. All of this comes together to create an enclosure able to meet all of the unique needs our customers have been seeking. DDB offers a state-of-the-art design, a competitive price, benchmark lead times and a guaranteed delivery, all backed up with an industry leading 15-year warranty on every enclosure. Put DDB's substantial stock to work for you today. Contact our professional staff to assist you with your made-to-order solution.

### Application Types

Telecommunications  
Wireless/Broadband  
Fiber Optics  
Back Haul  
Small Cell/DAS  
Public Safety  
Utility  
Base Station  
Military  
Trailer-Based Communications  
Wi-Fi  
LTEE/4G/5G



### Industry Standards:

NEMA 3R as shown  
NEMA 4 and 4X configurable (unlisted to environmental rating)  
**OD Series Listed to UL 50/50E Type 4 Available**  
ETL listed to UL Standard 60950-1/CSA 22.2C

2301 S. HWY 77 Pauls Valley, OK 73075

T: (800) 753-8459 – F: (877) 220-7236

[sales@ddbunlimited.com](mailto:sales@ddbunlimited.com) [www.ddbunlimited.com](http://www.ddbunlimited.com)



### Features

0.125" Aluminum Construction  
Stainless Steel External Hardware/Hinge  
3 Point Lock System  
Heavy Duty Out-Door Construction  
Front and Rear Access  
Custom Colors Available  
Cream and Red Powder-Coat in Stock  
Flexible and Scalable  
15 Year Warranty  
Quick Shipping

### Weight and Dimensions

Approximate Exterior Enclosure Dimensions:

32"H x 28"W x 30"D

Shipping Dimensions:

32"W x 42"L - Palletized

Approximate Shipping Weight:

126 lbs.

# OD Series

## OD-30DXC

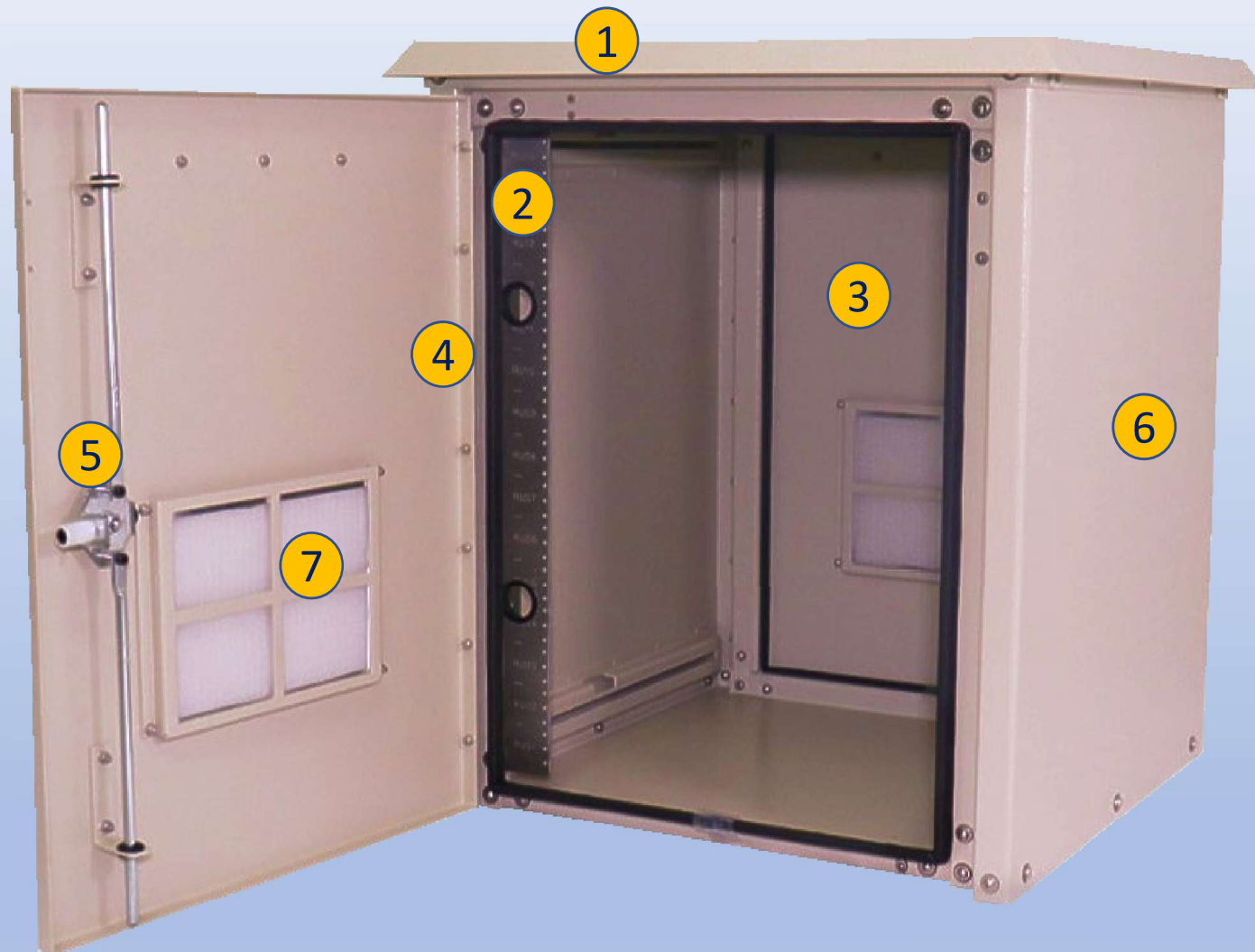

### Features

1. Solar Shield (Alumishield)
2. 19" Adjustable Racking Rails
3. Rear Access Door
4. Stainless Steel Door Hinge
5. 3 Point Locking System
6. Powder-Coat Cream
7. Reusable Vent Filters

2301 S. HWY 77 Pauls Valley, OK 73075

T: (800) 753-8459 – F: (877) 220-7236

[sales@ddbunlimited.com](mailto:sales@ddbunlimited.com) [www.ddbunlimited.com](http://www.ddbunlimited.com)

WEB DRAWING (NOT FOR FABRICATION)

REVISIONS		
REV.	DESCRIPTION	DATE
A	Web Drawing per DR-00423	11/10/2011
B	Update with new components and DWG template per DR-00917	5/2/2014
C	UPDATED WITH 2019 FORMAT	2/11/2019

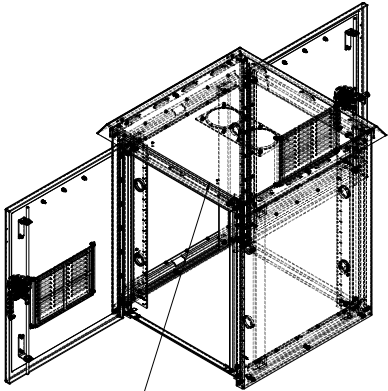
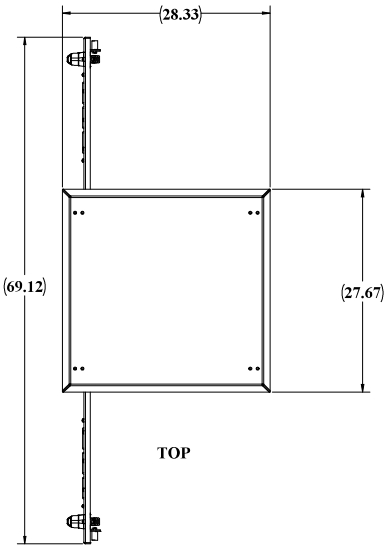

STANDOFFS STANDARD  
FOR OPTIONAL LIGHTING  
OVER EACH DOOR  
FRONT AND REAR

CEILING LOUVERS  
FRONT RAIL STANDARD

OPTIONAL REAR SET OF RAILS

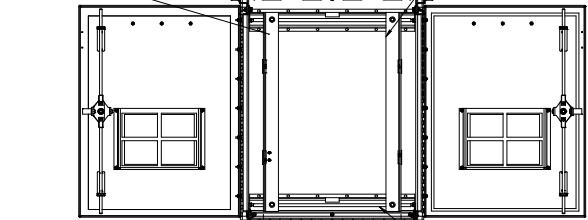

SECTION B-B  
SCALE 1 : 8

R-STRUTS  
FOR RAIL ADJUSTMENTS

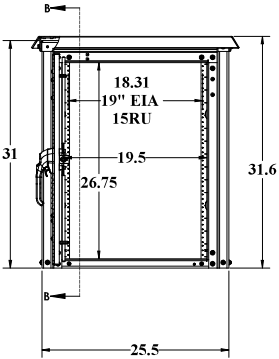

FRONT

3 POINT LOCKING  
EACH DOOR

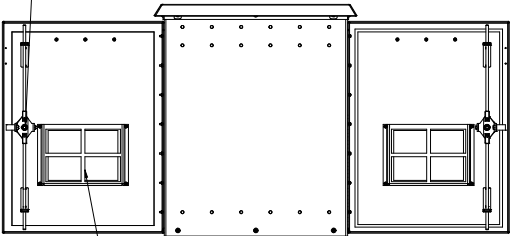

RIGHT SIDE  
FILTERED LOUVERS

WEB DRAWING (NOT FOR FABRICATION)

UNLESS OTHERWISE SPECIFIED:		NAME	DATE	DDB Unlimited Inc.			
DESCRIPTION AND QUANTITY		Model No.	1104-0001	OD Family Enclosures			
PARTS LIST		Drawn By:	Marcel	Enclosure, OD, 30, EX			
ASSEMBLY INSTRUCTIONS		Sales Rep:	www.Congentia.com	SITE			
MATERIALS		Q.A. Appr:	109	Cage Code:			
FINISH: ANODIZED ALUMINUM		Prod.Mgr:	Chad	DWG. NO.:			
DO NOT SCALE DRAWING		Created:	08/13/19	D			
		Scale:	1:32	WEIGHT: 93 lbs.			
		Sheet:	1	SHEET 1 OF 3			

WEB DRAWING (NOT FOR FABRICATION)

4X  $\phi \frac{1}{2}$ "  
ETCHING

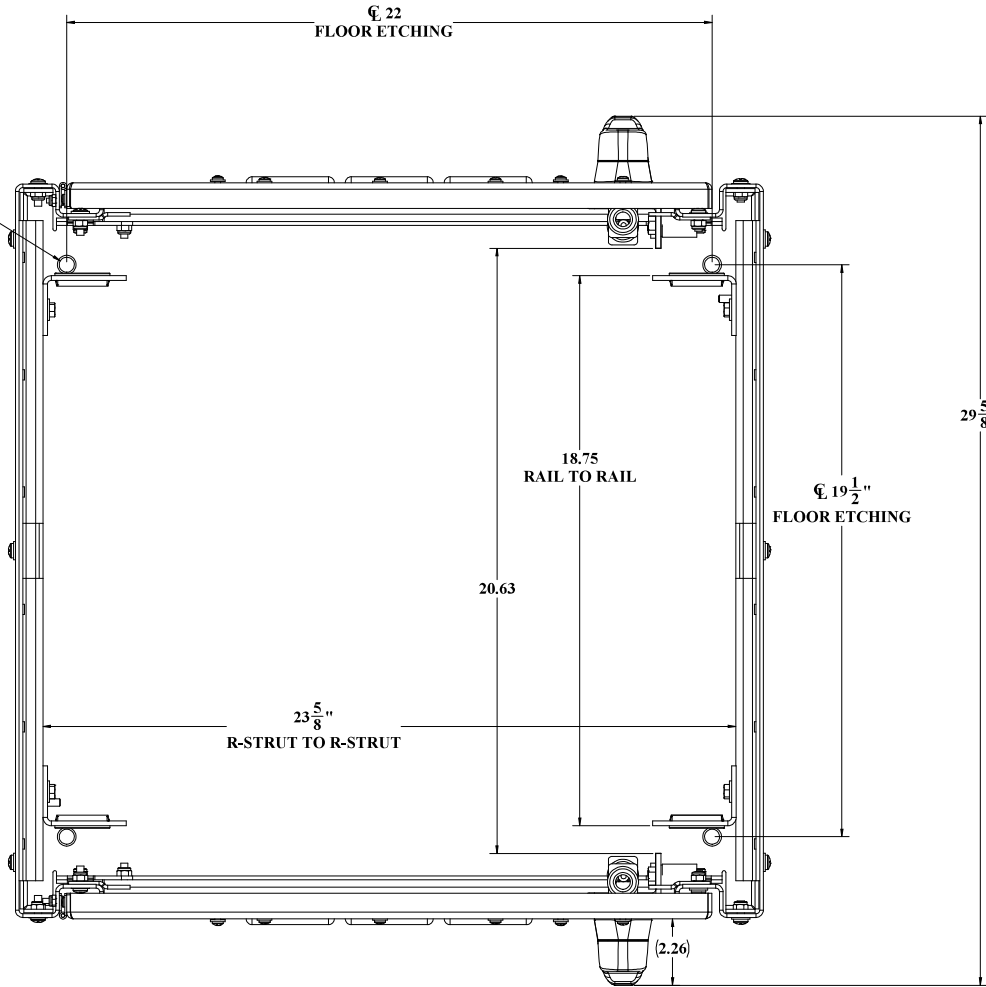

TOP VIEW CEILING AND ALUMASHIELD NOT SHOWN

WEB DRAWING (NOT FOR FABRICATION)

UNLESS OTHERWISE SPECIFIED:		NAME	DATE	<b>DDB Unlimited Inc.</b>			
DIMENSIONS ARE IN INCHES		Model No.	1008	OD Family Enclosures			
ANGULAR		Drawn By:	Marcel	OD Family Enclosure, DX, Closed			
ONE-PIECE/DOUBLE ENDING		Sales Rep./Rev. Control	14/13/11	SITE	Code Code:	DWG. NO.:	REV
COVER PLATE/DOUBLE ENDING		Q.A. Appr.	189				
TWO-PIECE/DOUBLE ENDING		Prod. Mgr.	14/13/11				
THREE PLATE/DOUBLE ENDING		Checked	14/13/11	D 38515			
ALL DIMENSIONS ARE TO CENTERLINE UNLESS OTHERWISE NOTED		Prod. Mgr.	14/13/11	00423 C			
MATERIAL: ALUMINUM EXTRUSION 6063-T5		Checked	14/13/11	SCALE: 1:32 WEIGHT: SHEET 2 OF 3			
FABRICATION: ALUMINUM EXTRUSION 6063-T5		DO NOT SCALE DRAWING					

WEB DRAWING (NOT FOR FABRICATION)

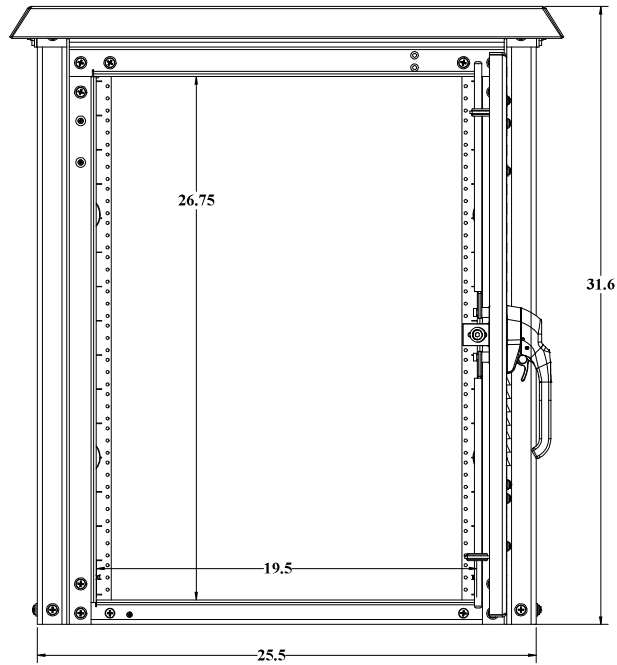

BACK VIEW GASKET NOW SHOWN

WEB DRAWING (NOT FOR FABRICATION)

UNLESS OTHERWISE SPECIFIED:		NAME	DATE	<b>DDB Unlimited Inc.</b>			
DIMENSIONS ARE IN INCHES		Model by:	0508	OD Family Endosources			
DETAILS		Drawn by:	Marcel	Endosources, OD, 30, DX			
SEE PLAN AND SECTION		Sales Representative	05/13/11	SITE	Cage Code:	DWG. NO.:	REV
SEE PLAN AND SECTION		Q.A. Appr:	189				
SEE PLAN AND SECTION		Prod.Mgr.:	08/13/10				
MATERIAL: 304 STAINLESS STEEL 1/2" THICK		DO NOT SCALE DRAWING		SCALE: 1:32		WEIGHT:	SHEET 3 OF 3
PAINT: ANTI-RUST PRIMER AND FINISH COAT							