



An ISO 9001
Certified company

ST Series

ST-42DX

Made in America



Believing in American
Craftsmanship



Why Choose the ST Series?

The ST series of enclosures are the ultimate choice for your indoor racking requirements. Being made of our own rugged Alumiflex®, you'll find it noticeably lighter than steel, yet strong enough to rack even the heaviest equipment. When choosing the ST series, you have handpicked the highest value in American construction. The ST-42DX includes the standard features you have come to expect with DDB, incorporating the versatile strut system for adjustable racking, the security of a lockable slam-latch system and easy clean filters. For those who need more than just our standard enclosure, DDB can also make a truly customized solution with our many available options including fan kits, heater strips, mounting trays, & cable management. All of this comes together to create an enclosure able to meet all of the unique needs our customers have been seeking. DDB offers a state-of-the-art design, a competitive price, benchmark lead times and a guaranteed delivery, all backed up with an industry leading 15-year warranty on every enclosure. Put DDB's substantial stock to work for you today. Contact our professional staff to assist you with your made-to-order solution.



Features

- 0.100" Aluminum Construction
- Stainless Steel External Hardware/Hinge
- Lockable Slam-Latch
- Heavy Duty Indoor Construction
- Front and Rear Access
- Custom Colors Available
- Cream Powder-Coat in Stock
- Flexible and Scalable
- 15 Year Warranty
- Quick Shipping

Application Types

Telecommunications
Wireless/Broadband
Fiber Optics
Data Centers
Server Rooms
Small Cell/DAS
Public Safety
Utility
Base Station
Wi-Fi
LTEE/4G/5G



Industry Standards:

NEMA 2 Rating as shown

2301 S. HWY 77 Pauls Valley, OK 73075
T: (800) 753-8459 – F: (877) 220-7236

sales@ddbunlimited.com www.ddbunlimited.com

Weight and Dimensions

Approximate Exterior Enclosure Dimensions:

43"H x 24"W x 26"D

Shipping Dimensions:

32" x 32" - Palletized

Approximate Shipping Weight:

95 lbs.

ST Series

ST-42DX

Made in America



Believing in American
Craftsmanship



Features

1. 19" Adjustable Racking Rails
2. Rear Access Door
3. Lockable Slam-Latch
4. Powder coat cream
5. Reusable Foam Filters

2301 S. HWY 77 Pauls Valley, OK 73075

T: (800) 753-8459 – F: (877) 220-7236

sales@ddbunlimited.com www.ddbunlimited.com

DDB FORM 7-1-2 REV E 04/25/13

A

B

C

D

E

F

G

H

WEB DRAWING (NOT FOR FABRICATION)

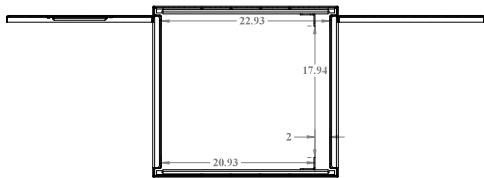

SECTION A-A
SCALE 1:8

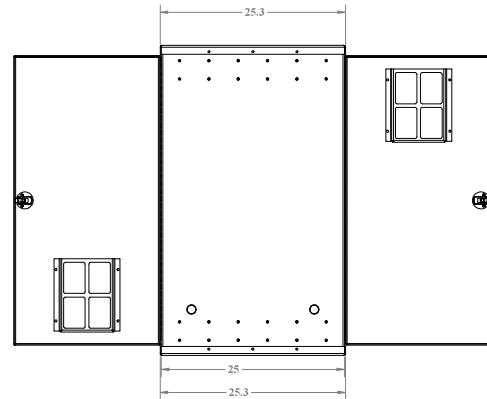
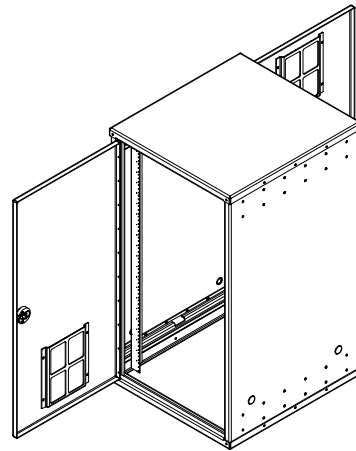
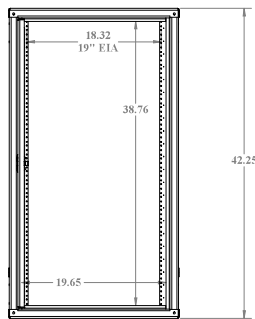
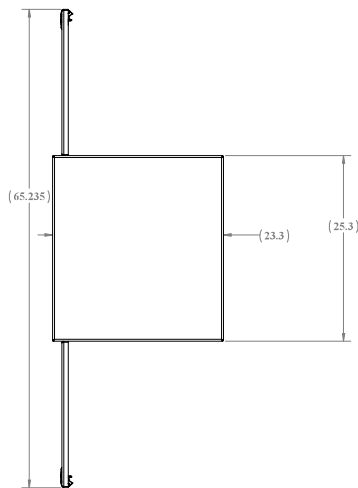

WEB DRAWING (NOT FOR FABRICATION)

NOTES: UNLESS OTHERWISE SPECIFIED

1. DIMENSIONS AND TOLERANCES ARE IN ACCORDANCE WITH ASME Y14.5M
2. DIMENSIONS ARE IN INCHES, UNLESS OTHERWISE SPECIFIED
3. THIS IS A SUPPLEMENTAL DRAWING AND MAY NOT BE FULLY DIMENSIONED. THE NOTES, TOLERANCES, AND SPECIAL INSTRUCTIONS ARE TO BE USED ALONG WITH THE LATEST REVISION OF THE SOLID DATABASE. THE PART OR ASSEMBLY IS TO BE CONTROLLED PER THE ELECTRONIC FILE
4. ALL PEM STUDS SHALL BE PHA FOR STAINLESS ENCLOSURES AND PHA FOR ALUMINUM
5. ALL EXTERIOR WASHERS SHALL BE SEALING WASHERS
6. THE FOLLOWING WEATHER STRIPPING SHALL BE USED FOR THE FOLLOWING APPLICATIONS:
DOOR LIP - TRIMLOCK 3100BX18C
FAN PLATES - STICKER-ITE 18x38
AC'S - STICKER-ITE 14x31
7. CUSTOM ENCLOSURES SHALL HAVE SECURITY TORX FOR ALL EXTERIOR HARDWARE
8. SYMBOL DENOTES CRITICAL DIMENSIONS AND MUST BE INSPECTED
9. REMOVE ALL BURRS AND CHAMFER EDGES 0.005" MAX RADIUS OR CHAMFER
10. DO NOT DRILL OR PRESS FIT HOLES
11. DIMENSIONS SHALL APPLY AFTER ALCOYNE PAINT, FINISH, OR COAT IS APPLIED
12. INSTALL PRESS FIT STANDOFFS, STUDS, AND NUTS IN ACCORDANCE WITH THE MANUFACTURER'S SPECIFICATIONS
13. ALL OPEN HOLES SHALL BE POPULATED WITH APPLICABLE HARDWARE
14. IDENTIFY PART WITH PART NUMBER, REVISION LETTER, AND SERIAL NUMBER
15. FINISHED PART TO BE FREE OF OILS, LUBRICANTS, AND OTHER CONTAMINANTS
16. DO NOT LOCK NUTS TO BE USED OR ANY PEM STUDS, UNLESS OTHERWISE SPECIFIED
17. ALL PEM STUDS WILL BE SECURED WITH EXTERNAL TOOTH WASHER AND STANDARD NUTS
18. TOLERANCES UNLESS OTHERWISE SPECIFIED:
a. HOLE SIZE: ± 0.003
b. HOLE TO HOLE: ± 0.005
c. HOLE TO EDGE: ± 0.010
d. HOLE TO FOLD: ± 0.015
e. FOLD TO FOLD: ± 0.020

4X $\phi 1$ THRU



UNLESS OTHERWISE SPECIFIED:
DIMENSIONS ARE IN INCHES
TOLERANCES
HOLE TO HOLE
HOLE TO EDGE
HOLE TO FOLD
FOLD TO FOLD

Model by: Marcus 06/05/17
Sales Rep: Steve 06/08/17
Prod. Mgr.: Chris 06/23/17

DDB Unlimited Inc.
ST-XXXX
ST-XXXXC
SITE: Cage Code: DWG. NO.: REV:
D 38515 A
SCALE: 1:12 WEEK: 72 lbs. SHEET 1 OF 1