



An ISO 9001
Certified company

WOD Series

WOD-30DXC



Why Choose the WOD Series?

The WOD series of enclosures are the ultimate choice for your outdoor racking requirements. Being made of our own rugged Alumiflex®, you'll find it noticeably lighter than steel, yet strong enough to rack even the heaviest equipment. When choosing the WOD series, you have handpicked the highest value in American construction. The WOD-30DXC includes the standard features you have come to expect with DDB, incorporating the versatile strut system for adjustable racking, the security of a 3-point locking system and our patented Alumishield® solar cap to manage heat loads. For those who need more than just our standard enclosure, DDB can also make a truly customized solution with our many available options including HVAC, providing a climate-controlled environment for any electronic equipment, electrical load panels and cable entry solutions to name a few. All of this comes together to create an enclosure able to meet all of the unique needs your customers have been seeking. DDB offers a state-of-the-art design, a competitive price, benchmark lead times and a guaranteed delivery, all backed up with an industry leading 15-year warranty on every enclosure. Put DDB's substantial stock to work for you today. Contact our professional staff to assist you with your made-to-order solution.

Application Types

Telecommunications
Wireless/Broadband
Fiber Optics
Back Haul
Small Cell/DAS
Public Safety
Utility
Base Station
Military
Trailer-Based Communications
Wi-Fi
LTEE/4G/5G



Industry Standards:

NEMA 3R as shown
NEMA 4 and 4X configurable (unlisted to environmental rating)
WOD Series Listed to UL 50/50E Type 4 Available
ETL listed to UL Standard 60950-1/CSA 22.2C

2301 S. HWY 77 Pauls Valley, OK 73075
T: (800) 753-8459 – F: (877) 220-7236
sales@ddbunlimited.com www.ddbunlimited.com



Features

0.125" Aluminum Construction
Stainless Steel External Hardware/Hinge
3 Point Lock System
Heavy Duty Out-Door Construction
Front and Rear Access
Custom Colors Available
Cream & Red Powder-Coat in Stock
Flexible and Scalable
15 Year Warranty
Quick Shipping

Weight and Dimensions

Approximate Exterior Enclosure Dimensions:
32"H x 32"W x 30"D
Shipping Dimensions:
32"W x 42"L - Palletized
Approximate Shipping Weight:
140 lbs.

WOD Series

WOD-30DXC



Features

1. Solar Shield (Alumishield)
2. 19" and 23" Reversible Racking Rails
3. Rear Access Door
4. Stainless Steel Door Hinge
5. 3 Point Locking System
6. Powder-Coat Cream
7. Reusable Vent Filters

2301 S. HWY 77 Pauls Valley, OK 73075

T: (800) 753-8459 – F: (877) 220-7236

sales@ddbunlimited.com www.ddbunlimited.com

WEB DRAWING (NOT FOR FABRICATION)

REVISIONS		
REV.	DESCRIPTION	DATE
A	Initial Web Drawing per DR-00134	6/10/2013
B	revise to incorporate new components and new drawing template pdr DR-00907	5/13/2014
C	UPDATED DRAWING TO NEW FORMAT PER DR-01939	4/10/2019
D	UPDATED DRAWING WITH DOOR RODS WITH ROLLERS PER DR-02268	4/24/2020

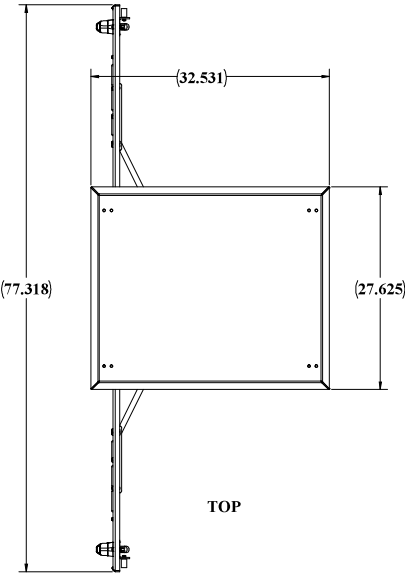

STANDOFFS ARE STANDARD FOR OPTIONAL LIGHTING OVER EACH DOOR FRONT AND REAR

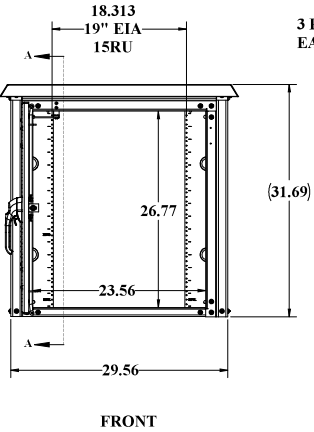
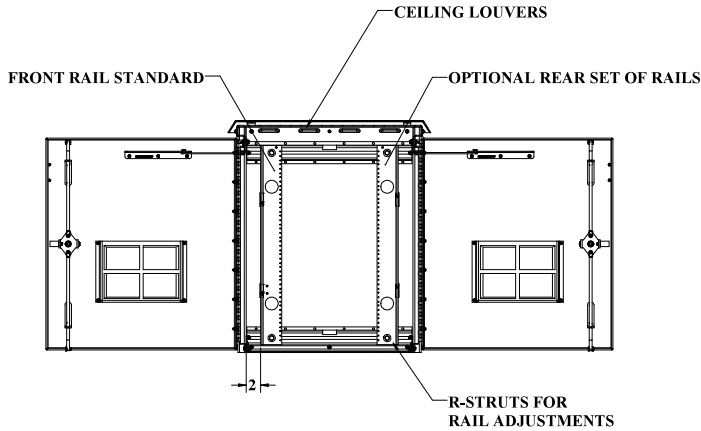
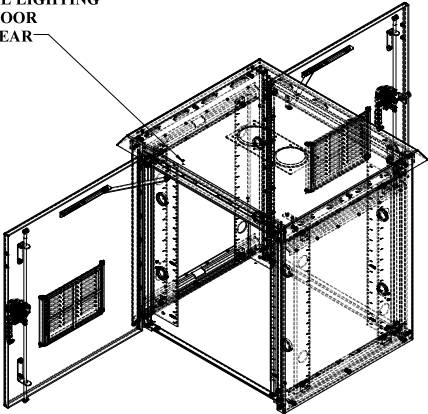

3 POINT LOCKING EACH DOOR

FILTERED LOUVERS

DOOR RODS WITH ROLLERS

STANDARD WINDLOCK EACH DOOR

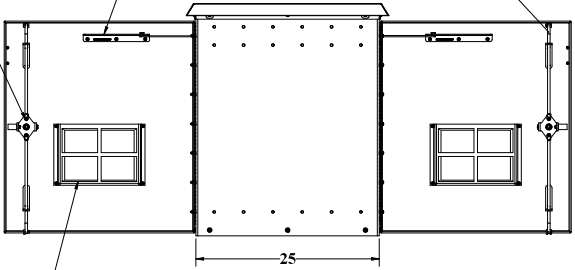

WEB DRAWING (NOT FOR FABRICATION)

UNLESS OTHERWISE SPECIFIED:			NAME DATE		
DESCRIPTION AND IN PHOTO			Model No.	0008	3/21/2018
ARTICULAR			Drawn by:	Revised	6/6/2020
DOOR RODS WITH ROLLERS			Sales Rep/rev	0008	6/6/2020
DOOR RODS WITH ROLLERS			Q.A. Appr.	Rev	6/6/2020
DOOR RODS WITH ROLLERS			Prod.Mgr.	Chk'd	6/6/2020
MATERIAL: 100% ALUMINUM 100% ALUMINUM			Created	Revised	6/6/2020
PARTS: 100% ALUMINUM 100% ALUMINUM			DO NOT SCALE DRAWING	2	
DDB Unlimited Inc.			File Location: (DDB) (PDM) (Vad)	88515	00267
WOD-XXXX			Cage Code:	DWC	NO.
WOD-30TH DX			REV	D	
SCALE: 1:12			WEIGHT: 114 lbs.	SHEET 1 OF 3	

UNCLASSIFIED PUBLIC

File Location: (DDB) (PDM) (Vad)

C:\DDB\Drawing Requests\Customers\WOD WEB DWG\WOD Family WEB\DR-00267 (WOD-30 WEB)

DDB FORM 7.1-2 REV F 05/02/19

A
B
C
D
E
F
G
H



UNCLASSIFIED PUBLIC

THE INFORMATION CONTAINED IN THIS DRAWING IS THE SOLE PROPERTY OF DDB Unlimited, INC. ANY REPRODUCTION IN PART OR AS A WHOLE WITHOUT THE WRITTEN PERMISSION OF DDB Unlimited, INC. IS PROHIBITED.

UNLESS OTHERWISE SPECIFIED:	
DIMENSIONS ARE IN INCHES	
ANGULAR FRONT FACE PLACEMENT TOP PLACE PLACEMENT RIGHT FACE PLACEMENT ALL OTHERS PER DIM.	
MATERIAL: 60-63 ALUMINUM 7050-T6 FINISH: Diamond Turn Body Class, Finish F-4219	
DO NOT SCALE DRAWING	

WEB DRAWING (NOT FOR FABRICATION)

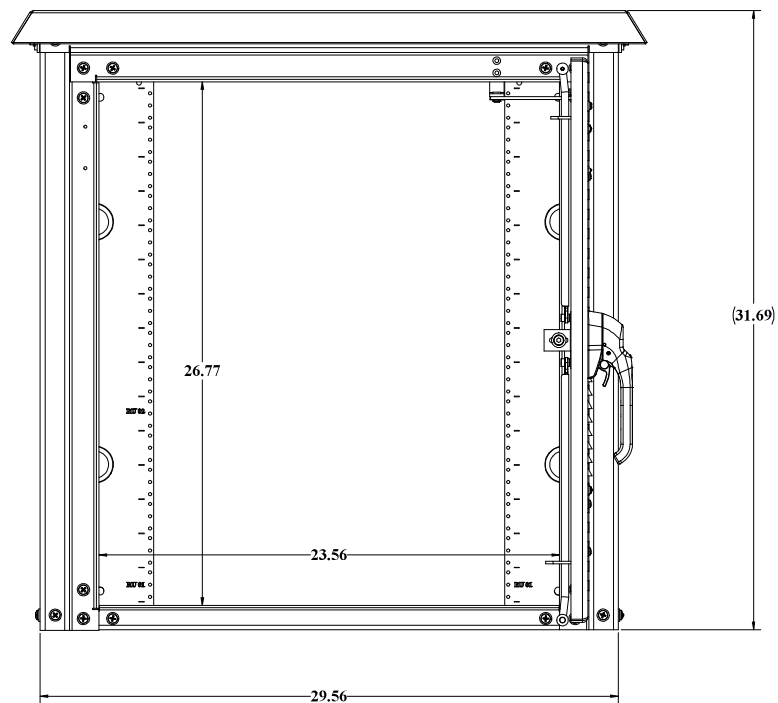

BACK VIEW
GASKET NOT SHOWN

WEB DRAWING (NOT FOR FABRICATION)

UNLESS OTHERWISE SPECIFIED:		DDb Unlimited Inc.	
DIMENSIONS ARE IN INCHES		WOD-30DX	
ANGULAR	1" = 40' 0"	WOD, 30" H, DX <div style="display: flex; justify-content: space-between;"> <div> SIZE D </div> <div> Cage Code: 38515 </div> <div> DWG. NO.: 00267 </div> <div> REV D </div> </div>	
FACE PLATE NO. DECIMAL	1" = 40' 0"		
ONE PLACE DECIMAL	1" = 40' 0"		
THREE PLACE DECIMAL	1" = 40' 0"		
THREE PLACE DECIMAL	1" = 40' 0"		
ALL HIDDEN POINTS		SCALE: 1:12	
MATERIAL: 90-041312-132* A573-64-3096-1		SHEET 3 OF 3	
TYPED: DIMENSIONS TO FACE UNLESS OTHERWISE NOTED			
DO NOT SCALE DIMENSIONS			

UNCLASSIFIED PUBLIC

THE INFORMATION CONTAINED IN THIS DRAWING IS THE SOLE PROPERTY OF DDB Unlimited, INC. ANY REPRODUCTION IN PART OR AS A WHOLE WITHOUT THE WRITTEN PERMISSION OF DDB Unlimited, INC. IS PROHIBITED.

File Location: (DD8)\EPDM Vault\;
C:\DD8\Drawing Requests\Customers\DD8 WEB DWG\WOD Family WEB\DR-00267 (WOD-30DX