



An ISO 9001/27001
Certified company

OD-UL Series

OD-16DXC-UL50

Made in America



Believing in American
Craftsmanship



Why Choose the OD-UL Series?

The OD-UL series of enclosures are the ultimate choice for your outdoor racking requirements. Being made of our own rugged Alumiflex®, you'll find it noticeably lighter than steel, yet strong enough to rack even the heaviest equipment. When choosing the OD-UL series, you have handpicked the highest value in American construction. The OD-UL series includes the standard features you have come to expect with DDB, incorporating the versatile strut system for adjustable racking, the security of a 3- point locking system, our patented Alumishield® solar cap to manage heat loads, UL listed grounding straps, & UL listed gasketing. For those who need more than just our standard enclosure, DDB can also make a truly customized solution with our many available options including HVAC, providing a climate-controlled environment for any electronic equipment, electrical load panels and cable entry solutions to name a few. All of this comes together to create an enclosure able to meet all of the unique needs your customers have been seeking. DDB offers a state-of-the-art design, a competitive price, benchmark lead times and a guaranteed delivery, all backed up with an industry leading 15-year warranty on every enclosure. Put DDB's substantial stock to work for you today. Contact our professional staff to assist you with your made-to-order solution.

Application Types

- Telecommunications
- Wireless/Broadband
- Fiber Optics
- Back Haul
- Small Cell/DAS
- Public Safety
- Utility
- Base Station
- Military
- Trailer-Based Communications
- Wi-Fi
- LTEE/4G/5G

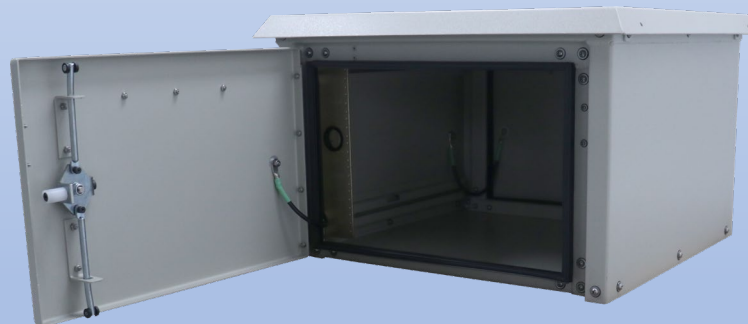

Environmental & Safety Ratings:

- ✓ ETL environmentally listed to UL 50/50E, IP 66, NEMA Type 4
- ✓ ETL listed; Safety Requirements, UL 62368-1:2019 Ed.3, CSA C22.2



Features

- 0.125" Aluminum Construction
- Stainless Steel External Hardware/Hinge
- Fully Welded Construction
- 3 Point Lock System
- Front and Rear Access
- Custom Colors Available
- Cream Powder-Coat in Stock
- Flexible and Scalable
- 15 Year Warranty
- Quick Shipping
- Water/Rain/Sleet/Dust Tight

Weight and Dimensions

Approximate Exterior Enclosure Dimensions:

18"H x 28"W x 30"D

Shipping Dimensions:

35"W x 42"L - Palletized

Approximate Shipping Weight:

95 lbs.

2301 S. HWY 77 Pauls Valley, OK 73075

T: (800) 753-8459 – F: (877) 220-7236

sales@ddbunlimited.com www.ddbunlimited.com

OD-UL Series

OD-16DXC-UL50

Made in America

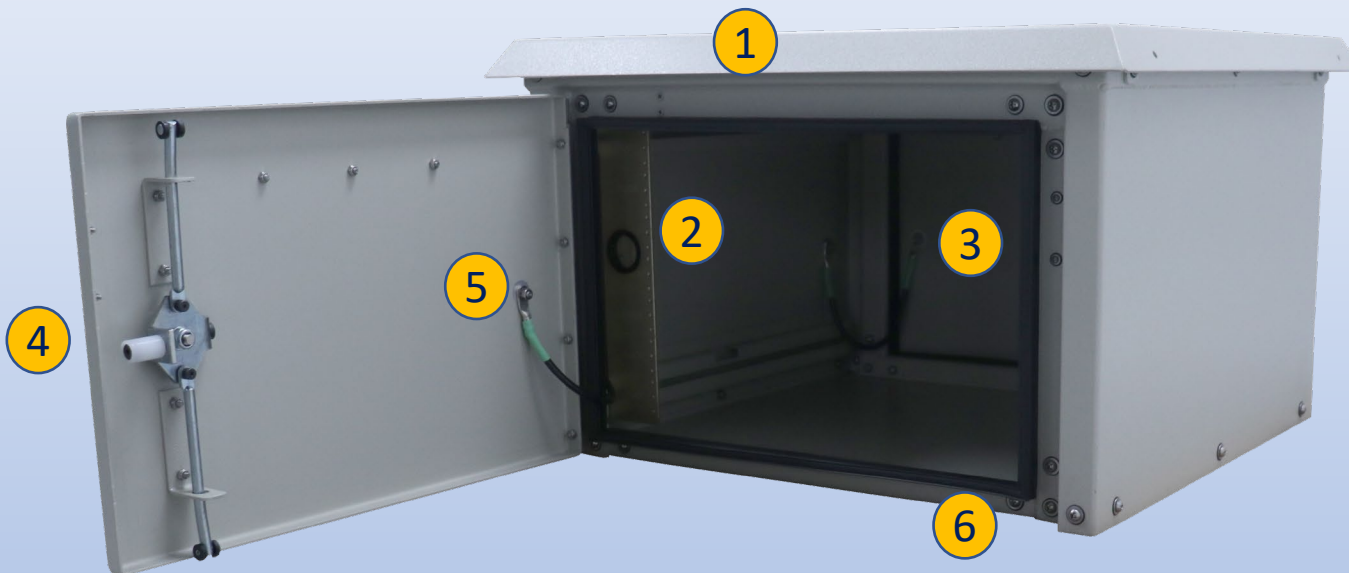
Believing in American
Craftsmanship

Features

1. Alumishield
2. 19", Adjustable, Racking Rails, 7 RU's
3. Rear Access Door
4. 3 Point Locking System
5. Ground Strap - UL Listed
6. Frame Gasket - UL Listed



Installation, operating and
safety instructions can be
downloaded here



Scan this code for
replacement parts



2301 S. HWY 77 Pauls Valley, OK 73075

T: (800) 753-8459 – F: (877) 220-7236

sales@ddbunlimited.com www.ddbunlimited.com

REVISIONS		
REV.	DESCRIPTION	DATE
A	OD-16DX-UL50	9/11/2018

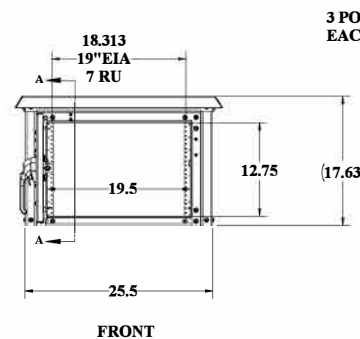
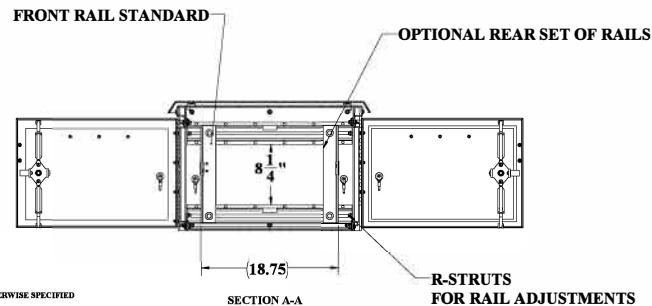
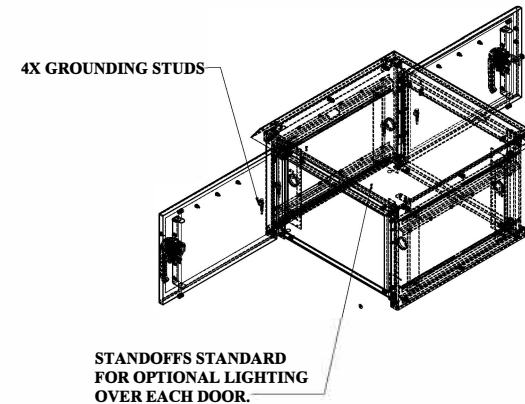
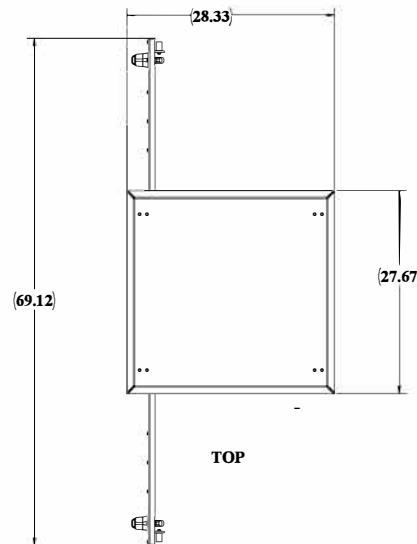

3 POINT LOCKING EACH DOOR

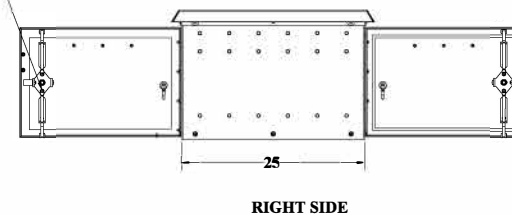

- NOTES: UNLESS OTHERWISE SPECIFIED
- DIMENSIONS AND TOLERANCES ARE IN ACCORDANCE WITH ASME Y14.5M
 - DIMENSIONS ARE IN INCHES, UNLESS OTHERWISE SPECIFIED
 - THIS IS A SUPPLEMENTAL DRAWING AND MAY NOT BE FULLY DIMENSIONED. THE NOTES, TOLERANCES, AND SPECIAL INSTRUCTIONS ARE TO BE USED ALONG WITH THE LATEST REVISION OF THE SOLID DATABASE. THE PART OR ASSEMBLY IS TO BE CONTROLLED PER THE ELECTRONIC FILE.
 - ALL PEM STUDS SHALL BE PER FOR STAINLESS ENCLOSURES AND TIA FOR ALUMINUM.
 - ALL EXTERIOR WASHERS SHALL BE SEALING WASHERS.
 - THE FOLLOWING WEATHER STRAPPING SHALL BE USED FOR THE FOLLOWING APPLICATIONS:
DOOR LIP - TRIM LOCK 1100B3X18C
FAN PLATES - STICKER-TITE 10A38
ACS - STICKER-TITE 10A31A
 - CUSTOM ENCLOSURES SHALL HAVE SECURITY TORX FOR ALL EXTERIOR HARDWARE.
 - SYMBOL: DENOTES CRITICAL DIMENSIONS AND MUST BE INSPECTED
 - REMOVE ALL BURRS AND SHARP EDGES 0.025" MAX RADIUS OR CHAMFER
 - DO NOT DEBURR PRESS FIT HOLES
 - DIMENSIONS SHALL APPLY AFTER ALUMINE, PAINT, FINISH OR COAT IS APPLIED
 - DO NOT PRESS FIT STANDOFFS, STUDS, AND NUTS IN ACCORDANCE WITH THE MANUFACTURER'S SPECIFICATIONS
 - ALL OPEN HOLES SHALL BE POPULATED WITH APPLICABLE HARDWARE
 - IDENTIFY PART WITH PART NUMBER, REVISION LETTER AND SERIAL NUMBER
 - FINISHED PART TO BE FREE OF OILS, LUBRICANTS, AND OTHER CONTAMINANTS
 - NO NYLON LOCK NUTS TO BE USED ON ANY PEM STUDS, UNLESS OTHERWISE SPECIFIED
 - ALL PEM STUDS WILL BE REQUIRED WITH EXTERNAL TOOTH WASHER AND STANDARD NUTS
 - TOLERANCES UNLESS OTHERWISE SPECIFIED:
a. HOLE SIZE: ± 0.005
b. HOLE TO HOLE: ± 0.005
c. HOLE TO EDGE: ± 0.010
d. HOLE TO FOLD: ± 0.015
e. FOLD TO FOLD: ± 0.020

WEB DRAWING (NOT FOR FABRICATION)

UNLESS OTHERWISE SPECIFIED:		NAME	DATE	DDB Unlimited Inc.			
DIMENSIONS ARE IN INCHES		Model by:	JBW	OD-16DX-UL50			
APPROVAL:		Drawn by:	Merich	Baltimore, MD, IL, TX, UL50			
DESIGNED BY: JLB		QA Appr:	Byrne C				
DESIGNED BY: JLB		Prod.Mgr.:	Chick				
PAINT: www.ddb.com		Scale:	1:1	WEIGHT: 47 LBS			
DO NOT SCALE DRAWING		Sheet:	2	REV 01842			

