



ISO 9001 & 27001
Certified company

OD Series

OD-62DXC



Believing in American
Craftsmanship



Why Choose the OD Series?

The OD series of enclosures are the ultimate choice for your outdoor racking requirements. Being made of our own rugged Alumiflex®, you'll find it noticeably lighter than steel, yet strong enough to rack even the heaviest equipment. When choosing the OD series, you have handpicked the highest value in American construction. The OD-62DXC includes the standard features you have come to expect with DDB, incorporating the versatile rail strut (R-Strut) system for adjustable racking, the security of a 3- point locking system and our patented Alumishield® solar cap to manage heat loads. For those who need more than just our standard enclosure, DDB can also make a truly customized solution with our many available options including HVAC, providing a climate-controlled environment for any electronic equipment, electrical load panels and cable entry solutions to name a few. All of this comes together to create an enclosure able to meet all of the unique needs your customers have been seeking. DDB offers a state-of-the-art design, a competitive price, benchmark lead times and a guaranteed delivery, all backed up with an industry leading 15-year warranty on every enclosure. Put DDB's substantial stock to work for you today. Contact our professional staff to assist you with your made-to-order solution.

Application Types

- Telecommunications
- Wireless/Broadband
 - Fiber Optics
 - Back Haul
- Small Cell/DAS
- Public Safety
- Utility
- Base Station
- Military
- Trailer-Based Communications
 - Wi-Fi
 - LTEE/4G/5G



Environmental & Safety Ratings:

- ✓ NEMA 3R (shown above)
- ✓ NEMA 4 and 4X configurable (not shown)
- ✓ OD-62 Series, ETL environmentally listed to UL 50/50E, Type 4's
Available here: <https://www.ddbunlimited.com/new-ul-50e-listed/>
- ✓ ETL listed; Safety Requirements, UL 62368-1:2019 Ed.3, CSA C22.2



Features

- 0.125" Aluminum Construction
- Stainless Steel External Hardware/Hinge
- 3 Point Lock System
- Heavy Duty Out-Door Construction
- Front and Rear Access
- Custom Colors Available
- Cream Powder-Coat in Stock
- Flexible and Scalable
- 15 Year Warranty
- Quick Shipping

Weight and Dimensions

Approximate Exterior Enclosure Dimensions:

63"H x 28"W x 30"D

Shipping Dimensions:

32"W x 42"L - Palletized

Approximate Shipping Weight:

182 lbs.

2301 S. HWY 77 Pauls Valley, OK 73075

T: (800) 753-8459 – F: (877) 220-7236

sales@ddbunlimited.com www.ddbunlimited.com

OD Series

OD-62DXC

Made in America
Believing in American
Craftsmanship

Features

1. Alumishield
2. 19" Adjustable Racking Rails, 33 RU's
3. Rear Access Door
4. Stainless Steel Door Hinge
5. 3 Point Locking System
6. Powder-Coat Cream
7. Reusable Vent Filters

Installation, operating and
safety instructions can be
downloaded hereScan this code for
replacement parts

2301 S. HWY 77 Pauls Valley, OK 73075

T: (800) 753-8459 – F: (877) 220-7236

sales@ddbunlimited.com www.ddbunlimited.com

WEB DRAWING (NOT FOR FABRICATION)

| REVISIONS | | |
|-----------|---|------------|
| REV. | DESCRIPTION | DATE |
| A | Web Drawing per DR-00425 | 11/15/2011 |
| B | Add new components and DWG template to WEB DWG per DR-00923 | 5/12/2014 |
| C | UPDATED DRAWING FORMAT PER DR-01945 | 5/23/2019 |
| D | UPDATED DRAWING WITH DOOR RODS WITH ROLLERS PER DR-02259 | 4/9/2020 |

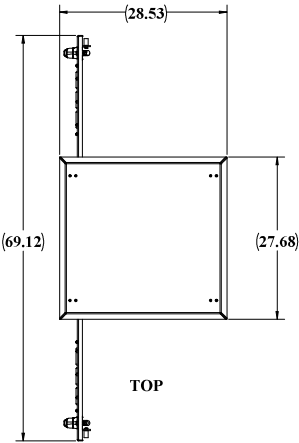

STANDOFFS STANDARD FOR OPTIONAL LIGHTING OVER EACH DOOR

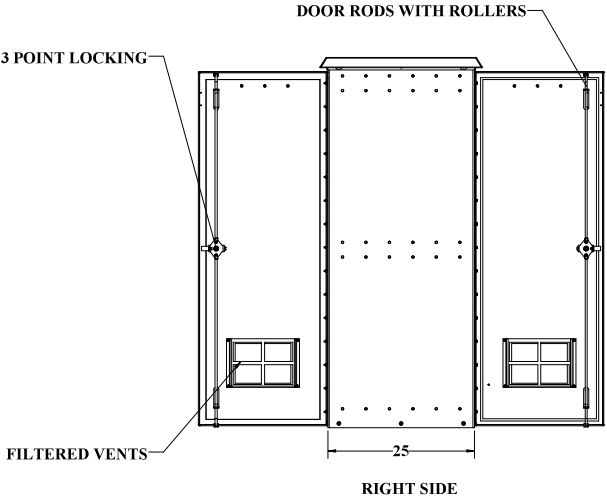
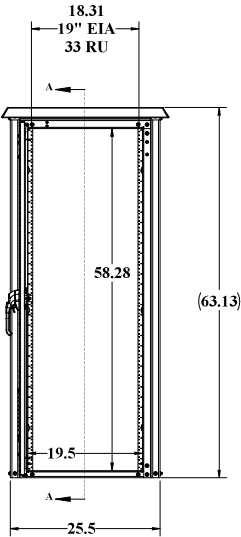
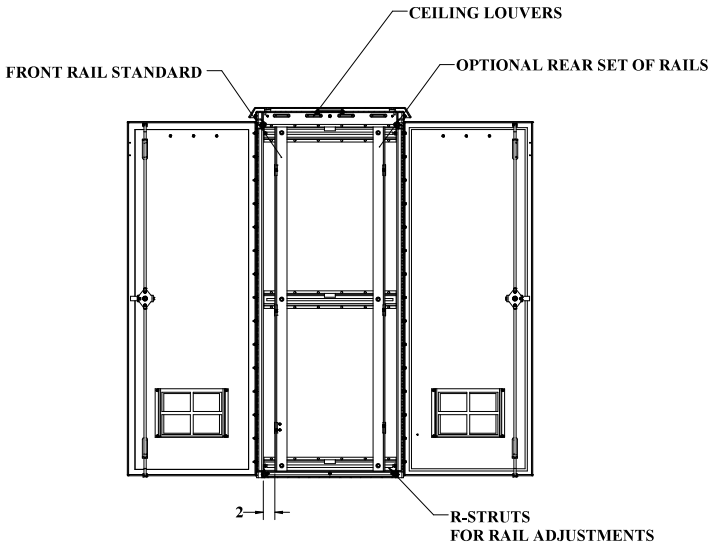
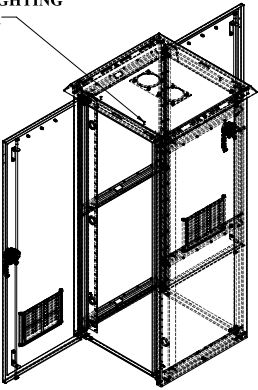

WEB DRAWING (NOT FOR FABRICATION)

| UNLESS OTHERWISE SPECIFIED: | | NAME | DATE | DDB Unlimited Inc. | | |
|-----------------------------|--|------------|-----------|-----------------------|----------|--------------|
| DESCRIPTION AND IN PHOTO | | Model No. | 1107-2081 | OD Family Endnotes | | |
| ARTICULAR | | Drawn by: | terese | Enclosure, OD, 62, DX | | |
| SIZE AND SCALE | | Sales Rep. | Boys C | 11/16/11 | | |
| MATERIALS | | Q.A. Appr. | May | 64/20/20 | | |
| PAINTS | | Prod. Mgr. | Chad | 64/21/20 | | |
| DO NOT SCALE DRAWING | | Scale | 1:32 | Weight | 149 lbs. | SHEET 1 OF 3 |

UNCLASSIFIED PUBLIC

File Location: (DDB)\(PDM Vault)\C:\DDB\Drawing Requests\Customers\ODS WEB DWG\OD Family WEB\DR-00429 (OD-62)X

WEB DRAWING (NOT FOR FABRICATION)

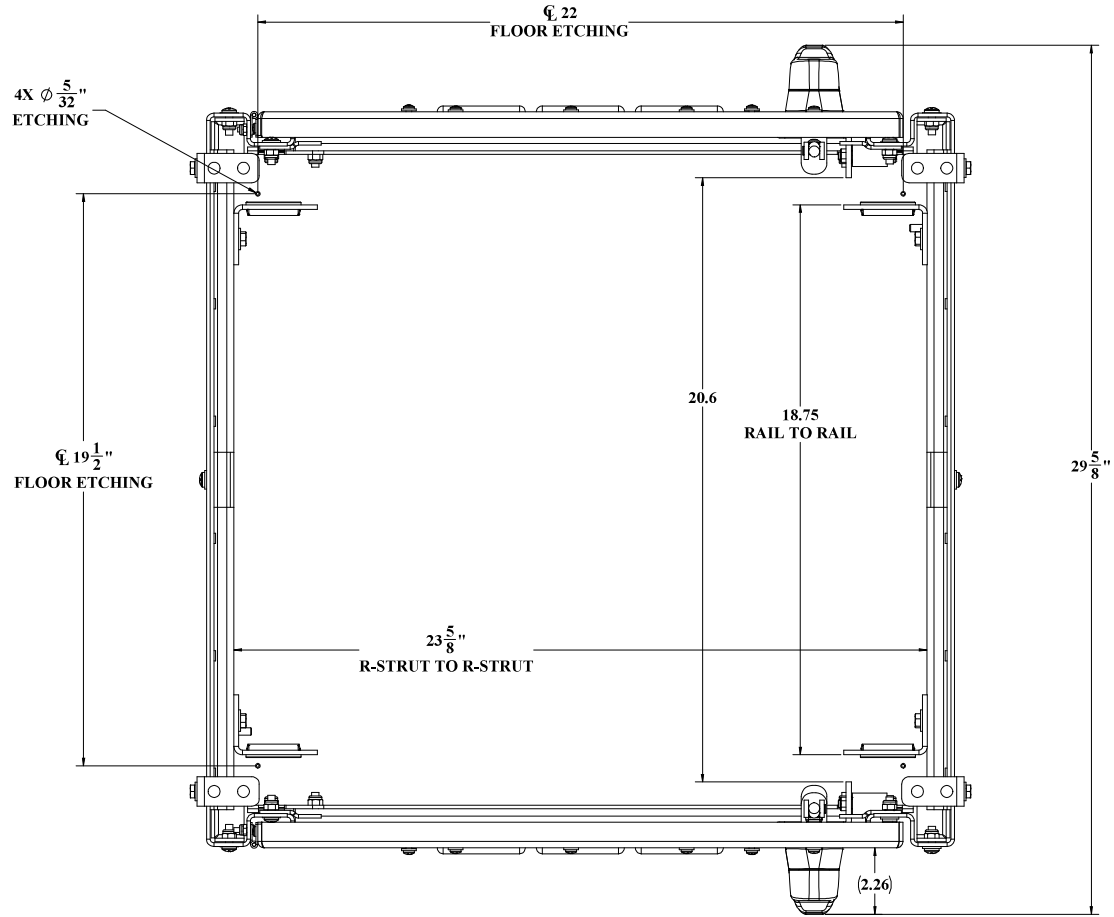

TOP VIEW CEILING AND ALUMASHIELD NOT SHOWN

WEB DRAWING (NOT FOR FABRICATION)

| | | | |
|-----------------------------|--|--------------------|--|
| UNLESS OTHERWISE SPECIFIED: | | DDR Unlimited Inc. | |
| DIMENSIONS ARE IN INCHES | | DX Closed | |
| ANGULAR | 1" | | |
| FRAMING/ROOFING | 1/2" | | |
| FRAMING/ROOFING | 1/4" | | |
| FRAMING/ROOFING | 1/8" | | |
| FRAMING/ROOFING | 1/16" | | |
| FRAMING/ROOFING | 1/32" | | |
| FRAMING/ROOFING | 1/64" | | |
| FRAMING/ROOFING | 1/128" | | |
| FRAMING/ROOFING | 1/256" | | |
| FRAMING/ROOFING | 1/512" | | |
| FRAMING/ROOFING | 1/1024" | | |
| FRAMING/ROOFING | 1/2048" | | |
| FRAMING/ROOFING | 1/4096" | | |
| FRAMING/ROOFING | 1/8192" | | |
| FRAMING/ROOFING | 1/16384" | | |
| FRAMING/ROOFING | 1/32768" | | |
| FRAMING/ROOFING | 1/65536" | | |
| FRAMING/ROOFING | 1/131072" | | |
| FRAMING/ROOFING | 1/262144" | | |
| FRAMING/ROOFING | 1/524288" | | |
| FRAMING/ROOFING | 1/1048576" | | |
| FRAMING/ROOFING | 1/2097152" | | |
| FRAMING/ROOFING | 1/4194304" | | |
| FRAMING/ROOFING | 1/8388608" | | |
| FRAMING/ROOFING | 1/16777216" | | |
| FRAMING/ROOFING | 1/33554432" | | |
| FRAMING/ROOFING | 1/67108864" | | |
| FRAMING/ROOFING | 1/134217728" | | |
| FRAMING/ROOFING | 1/268435456" | | |
| FRAMING/ROOFING | 1/536870912" | | |
| FRAMING/ROOFING | 1/1073741824" | | |
| FRAMING/ROOFING | 1/2147483648" | | |
| FRAMING/ROOFING | 1/4294967296" | | |
| FRAMING/ROOFING | 1/8589934592" | | |
| FRAMING/ROOFING | 1/17179869184" | | |
| FRAMING/ROOFING | 1/34359738368" | | |
| FRAMING/ROOFING | 1/68719476736" | | |
| FRAMING/ROOFING | 1/137438953472" | | |
| FRAMING/ROOFING | 1/274877906944" | | |
| FRAMING/ROOFING | 1/549755813888" | | |
| FRAMING/ROOFING | 1/1099511627776" | | |
| FRAMING/ROOFING | 1/2199023255552" | | |
| FRAMING/ROOFING | 1/4398046511104" | | |
| FRAMING/ROOFING | 1/8796093022208" | | |
| FRAMING/ROOFING | 1/17592186044416" | | |
| FRAMING/ROOFING | 1/35184372088832" | | |
| FRAMING/ROOFING | 1/70368744177664" | | |
| FRAMING/ROOFING | 1/140737488355328" | | |
| FRAMING/ROOFING | 1/281474976710656" | | |
| FRAMING/ROOFING | 1/562949953421312" | | |
| FRAMING/ROOFING | 1/1125899906842624" | | |
| FRAMING/ROOFING | 1/2251799813685248" | | |
| FRAMING/ROOFING | 1/4503599627370496" | | |
| FRAMING/ROOFING | 1/9007199254740992" | | |
| FRAMING/ROOFING | 1/18014398509481984" | | |
| FRAMING/ROOFING | 1/36028797018963968" | | |
| FRAMING/ROOFING | 1/72057594037927936" | | |
| FRAMING/ROOFING | 1/144115188075855872" | | |
| FRAMING/ROOFING | 1/288230376151711744" | | |
| FRAMING/ROOFING | 1/576460752303423488" | | |
| FRAMING/ROOFING | 1/1152921504606846976" | | |
| FRAMING/ROOFING | 1/2305843009213693952" | | |
| FRAMING/ROOFING | 1/4611686018427387904" | | |
| FRAMING/ROOFING | 1/9223372036854775808" | | |
| FRAMING/ROOFING | 1/18446744073709551616" | | |
| FRAMING/ROOFING | 1/36893488147419103232" | | |
| FRAMING/ROOFING | 1/73786976294838206464" | | |
| FRAMING/ROOFING | 1/147573952589676412928" | | |
| FRAMING/ROOFING | 1/295147905179352825856" | | |
| FRAMING/ROOFING | 1/590295810358705651712" | | |
| FRAMING/ROOFING | 1/1180591620717411303424" | | |
| FRAMING/ROOFING | 1/2361183241434822606848" | | |
| FRAMING/ROOFING | 1/4722366482869645213696" | | |
| FRAMING/ROOFING | 1/9444732965739290427392" | | |
| FRAMING/ROOFING | 1/188894659314785808478848" | | |
| FRAMING/ROOFING | 1/37778931862957161709568" | | |
| FRAMING/ROOFING | 1/75557863725914323419136" | | |
| FRAMING/ROOFING | 1/151115727451828646838272" | | |
| FRAMING/ROOFING | 1/302231454903657293676544" | | |
| FRAMING/ROOFING | 1/604462909807314587353088" | | |
| FRAMING/ROOFING | 1/1208925819614629174706176" | | |
| FRAMING/ROOFING | 1/2417851639229258349412352" | | |
| FRAMING/ROOFING | 1/4835703278458516698824704" | | |
| FRAMING/ROOFING | 1/9671406556917033397649408" | | |
| FRAMING/ROOFING | 1/19342813113834066795298816" | | |
| FRAMING/ROOFING | 1/38685626227668133590597632" | | |
| FRAMING/ROOFING | 1/77371252455336267181195264" | | |
| FRAMING/ROOFING | 1/154742504910672534362390528" | | |
| FRAMING/ROOFING | 1/309485009821345068724781056" | | |
| FRAMING/ROOFING | 1/618970019642690137449562112" | | |
| FRAMING/ROOFING | 1/1237940039285380274899124224" | | |
| FRAMING/ROOFING | 1/2475880078570760549798248448" | | |
| FRAMING/ROOFING | 1/4951760157141521099596496896" | | |
| FRAMING/ROOFING | 1/9903520314283042199192993792" | | |
| FRAMING/ROOFING | 1/19807040628566084398385987584" | | |
| FRAMING/ROOFING | 1/39614081257132168796771975168" | | |
| FRAMING/ROOFING | 1/79228162514264337593543950336" | | |
| FRAMING/ROOFING | 1/158456325028528675187087900672" | | |
| FRAMING/ROOFING | 1/316912650057057350374175801344" | | |
| FRAMING/ROOFING | 1/633825300114114700748351602688" | | |
| FRAMING/ROOFING | 1/1267650600228229401496703205376" | | |
| FRAMING/ROOFING | 1/2535301200456458802993406410752" | | |
| FRAMING/ROOFING | 1/5070602400912917605986812821504" | | |
| FRAMING/ROOFING | 1/10141204801825835211973625643008" | | |
| FRAMING/ROOFING | 1/20282409603651670423947251286016" | | |
| FRAMING/ROOFING | 1/40564819207303340847894502572032" | | |
| FRAMING/ROOFING | 1/81129638414606681695789005144064" | | |
| FRAMING/ROOFING | 1/1622592768292133633915228241121378304" | | |
| FRAMING/ROOFING | 1/324518553658426726783156020576256" | | |
| FRAMING/ROOFING | 1/64903710731685345356631204115251378304" | | |
| FRAMING/ROOFING | 1/12980742146337069071326240823050266304" | | |
| FRAMING/ROOFING | 1/259614842926741381426524816461005266304" | | |
| FRAMING/ROOFING | 1/51922968585348276285304963292205266304" | | |
| FRAMING/ROOFING | 1/103845937170696552570609926584405266304" | | |
| FRAMING/ROOFING | 1/207691874341393105141219853168805266304" | | |
| FRAMING/ROOFING | 1/415383748682786210282439706337605266304" | | |
| FRAMING/ROOFING | 1/830767497365572420564879412675205266304" | | |
| FRAMING/ROOFING | 1/1661534994731144841129758825350405266304" | | |
| FRAMING/ROOFING | 1/3323069989462289682259517650700805266304" | | |
| FRAMING/ROOFING | 1/6646139978924579364519035301401605266304" | | |
| FRAMING/ROOFING | 1/1329227995784915872903807060280305266304" | | |
| FRAMING/ROOFING | 1/2658455991569831745807614120560605266304" | | |
| FRAMING/ROOFING | 1/5316911983139663491615228241121305266304" | | |
| FRAMING/ROOFING | 1/1063382396627932692323045648224205266304" | | |
| FRAMING/ROOFING | 1/2126764793255865384646091296448405266304" | | |
| FRAMING/ROOFING | 1/4253529586511730769292182592896805266304" | | |
| FRAMING/ROOFING | 1/8507059173023461538584365185793605266304" | | |
| FRAMING/ROOFING | 1/17014118346046923173168730371587205266304" | | |
| FRAMING/ROOFING | 1/3402823669209384634633746074316805266304" | | |
| FRAMING/ROOFING | 1/6805647338418769269267492148633605266304" | | |
| FRAMING/ROOFING | 1/136112946768375385385349842972667205266304" | | |
| FRAMING/ROOFING | 1/272225893536750770770699685945334405266304" | | |
| FRAMING/ROOFING | 1/544451787073501541541399371890668805266304" | | |
| FRAMING/ROOFING | 1/1088903574147003083082798743781337605266304" | | |
| FRAMING/ROOFING | 1/2177807148294006166165597487562675205266304" | | |
| FRAMING/ROOFING | 1/4355614296588012332331194975125350405266304" | | |
| FRAMING/ROOFING | 1/8711228593176024664662389950250700805266304" | | |
| FRAMING/ROOFING | 1/1742245718635204932932477990050350405266304" | | |
| FRAMING/ROOFING | 1/3484491437270409865864955980100700805266304" | | |
| FRAMING/ROOFING | 1/6968982874540819731729911960201401605266304" | | |
| FRAMING/ROOFING | 1/1393796574908163946345982392040280305266304" | | |
| FRAMING/ROOFING | 1/27875931498163278926919647840805605266304" | | |
| FRAMING/ROOFING | 1/557518629963265578538392956816011205266304" | | |
| FRAMING/ROOFING | 1/11150372599265311570767859136022405266304" | | |
| FRAMING/ROOFING | 1/22300745198530623141535718272604405266304" | | |
| FRAMING/ROOFING | 1/4460149039706124628307143654508805266304" | | |
| FRAMING/ROOFING | 1/8920298079412249256614287309017605266304" | | |
| FRAMING/ROOFING | 1/17840596158824498513228574618035205266304" | | |
| FRAMING/ROOFING | 1/35681192317648997026457149236070405266304" | | |
| FRAMING/ROOFING | 1/71362384635297994052914298472140805266304" | | |
| FRAMING/ROOFING | 1/14272476927059598091018424163021605266304" | | |
| FRAMING/ROOFING | 1/28544953854119197621165719388043205266304" | | |
| FRAMING/ROOFING | 1/57089907708238395242331438776086405266304" | | |
| FRAMING/ROOFING | 1/114179815416476790484662877550172805266304" | | |
| FRAMING/ROOFING | 1/228359630832953580969325755100345605266304" | | |
| FRAMING/ROOFING | 1/456719261665907161938651510200691205266304" | | |
| FRAMING/ROOFING | 1/913438523331814323877303020401382405266304" | | |
| FRAMING/ROOFING | 1/182687704666362864775460604080275205266304" | | |
| FRAMING/ROOFING | 1/365375409332725729550921208160550405266304" | | |
| FRAMING/ROOFING | 1/7307508186654514591018424163201100805266304" | | |
| FRAMING/ROOFING | 1/1461501637330902918203684832640220805266304" | | |
| FRAMING/ROOFING | 1/2923003274661805836407369665280441605266304" | | |
| FRAMING/ROOFING | 1/5846006549323611672814739330560883205266304" | | |
| FRAMING/ROOFING | 1/11692013098647223345629478661121766405266304" | | |
| FRAMING/ROOFING | 1/23384026197294446691258957322243526405266304" | | |
| FRAMING/ROOFING | 1/46768052394588893382517914644487046405266304" | | |
| FRAMING/ROOFING | 1/935361047891777867650358292889614086405266304" | | |
| FRAMING/ROOFING | 1/18707220957835557353007165877792217605266304" | | |
| FRAMING/ROOFING | 1/37414441915671114706014331716784435205266304" | | |
| FRAMING/ROOFING | 1/74828883831342229412 | | |

WEB DRAWING (NOT FOR FABRICATION)

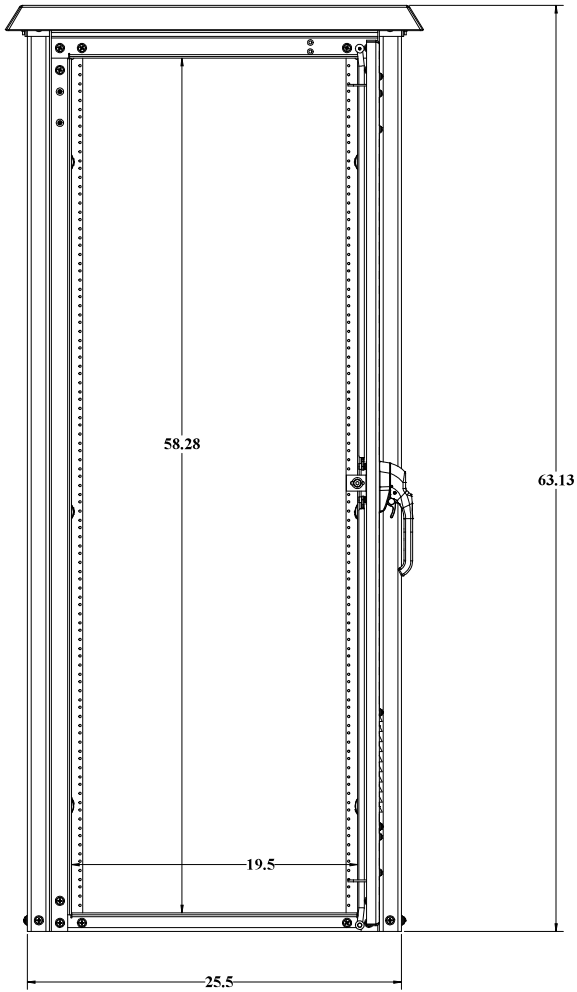

BACK VIEW GASKET NOT SHOWN

WEB DRAWING (NOT FOR FABRICATION)

| UNLESS OTHERWISE SPECIFIED: | |
|-------------------------------|-------------|
| DIMENSIONS ARE IN INCHES | |
| ANGLE/SLANT | 1° ±0.002 |
| FRONT VIEW | 1/8" ±0.002 |
| TOP VIEW | 1/8" ±0.002 |
| RIGHT SIDE VIEW | 1/8" ±0.002 |
| LEFT SIDE VIEW | 1/8" ±0.002 |
| ALL DIMENSIONS | ±0.005 |
| MATERIAL: 304 STAINLESS STEEL | |
| FINISH: POLISHED | |
| DO NOT SCALE DRAWING | |

| | | | |
|---------------------------|------------|-----------|--------------|
| DDB Unlimited Inc. | | | |
| OD-42DX | | | |
| Enclosure, OD, 42, DX | | | |
| REV | Code Code: | DWG. NO.: | REV |
| D | 28515 | 00429 | - |
| SCALE: 1:32 | | WEIGHT: | SHEET 2 OF 3 |

UNCLASSIFIED PUBLIC
THE INFORMATION CONTAINED IN THIS DRAWING IS THE SOLE PROPERTY OF DDB Unlimited, INC. ANY
REPRODUCTION IN PART OR AS A WHOLE WITHOUT THE WRITTEN PERMISSION OF DDB Unlimited, INC. IS PROHIBITED.

File Location: (DDB) (PDM Vault):
C:\DDB\Drawing Requests\Customers\ODS WEB DWG\OD Family WEB\DR-00429 (OD-42DX)\